



# Capital Planning and Facility Operations for COVID-19

All attendees have been muted

Please use the chat box to introduce yourself and chat with colleagues.

# Land Acknowledgement

In the spirit of Truth and Reconciliation, we recognize that our work takes place on traditional lands of the Indigenous peoples who have inhabited this territory since the beginning.

We are grateful for the opportunity to work on this land and are mindful of broken covenants and strive to make this right, with the land and with each other.

# Your Zoom Controls

## Use the Chat box:

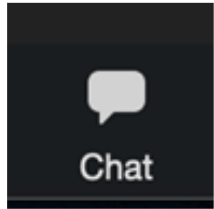

- For technical questions
- To introduce yourself
- To *chat* with other attendees
- Use the drop down menu to chat with All Attendees or Panellists

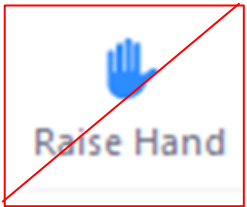

**Use the Chat Box instead of the Raise Hand feature**

## Use the Q&A box:

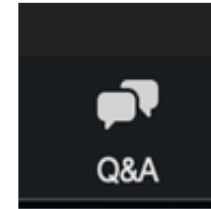

- To ask a panellist a question
- Use the Thumbs Up to “up vote” a question you would like answered

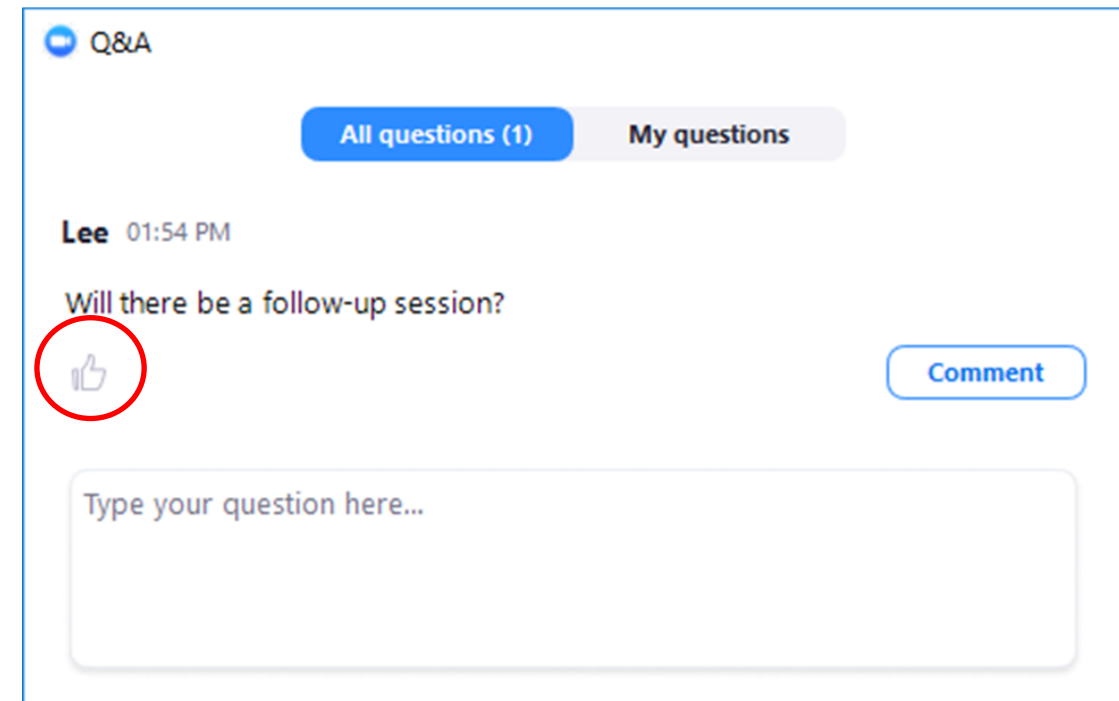

**You may be able to adjust your view of the slides and presenters**



# Panelists

**Viktors Jaunkalns** OAA Architect AIBC AAA NSAA SAA UIA SCUP FRAIC  
**Founding Partner, MJMA**

**Deepu Balaraman** B. Arch (Hons.), LEED, PMP  
**Vice President, Colliers Project Leaders**

**John Frittenburg**  
**Founder and President, The JF Group**

# Agenda

- **Design and Architectural Considerations,**  
Viktors Jaunkalns
- **Project Delivery during COVID-19 and  
beyond,** Deepu Balaraman
- **Operational Implications in a Post COVID  
World,** John Frittenburg



# MJMA







Customer Service







67SM

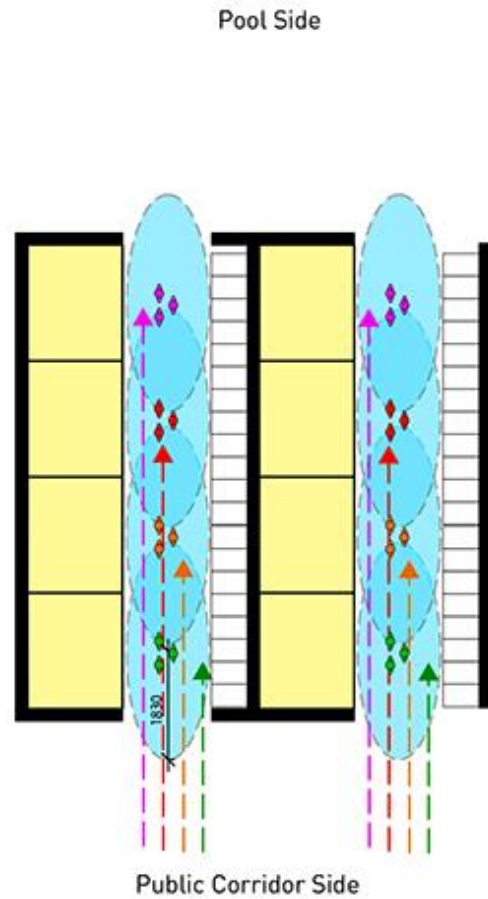

Typical Change Module

96 M [+46%]

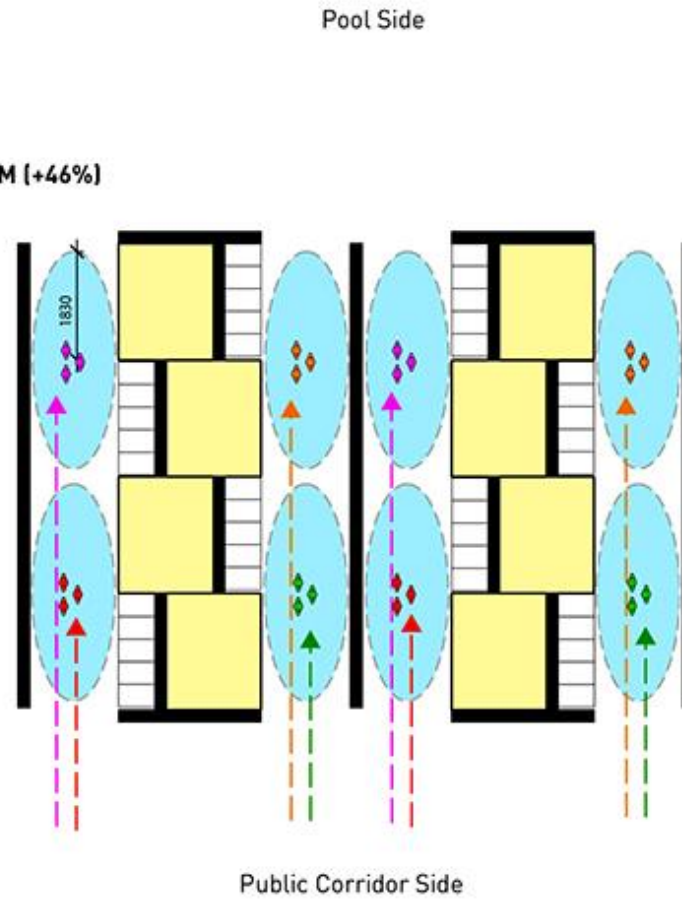

Change Module  
Maximizing Personal Space

96 M [+46%]

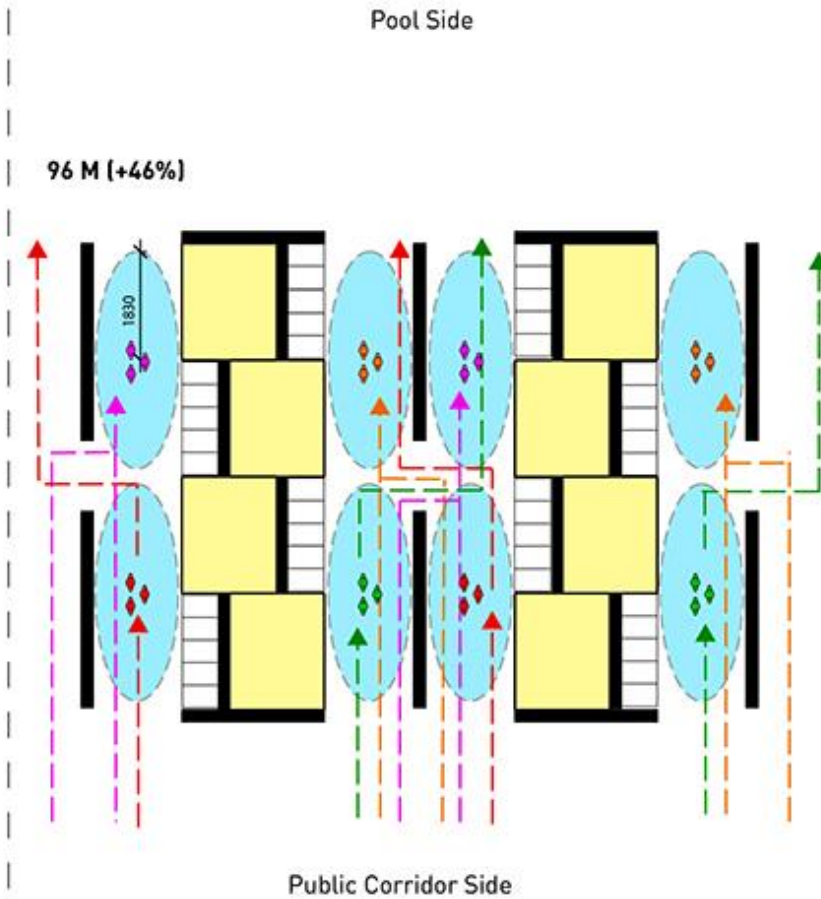

Change Module  
Maximizing Personal Space  
Increasing 'Flow' Options



**Open Deck showers**  
University of British Columbia Aquatic Centre



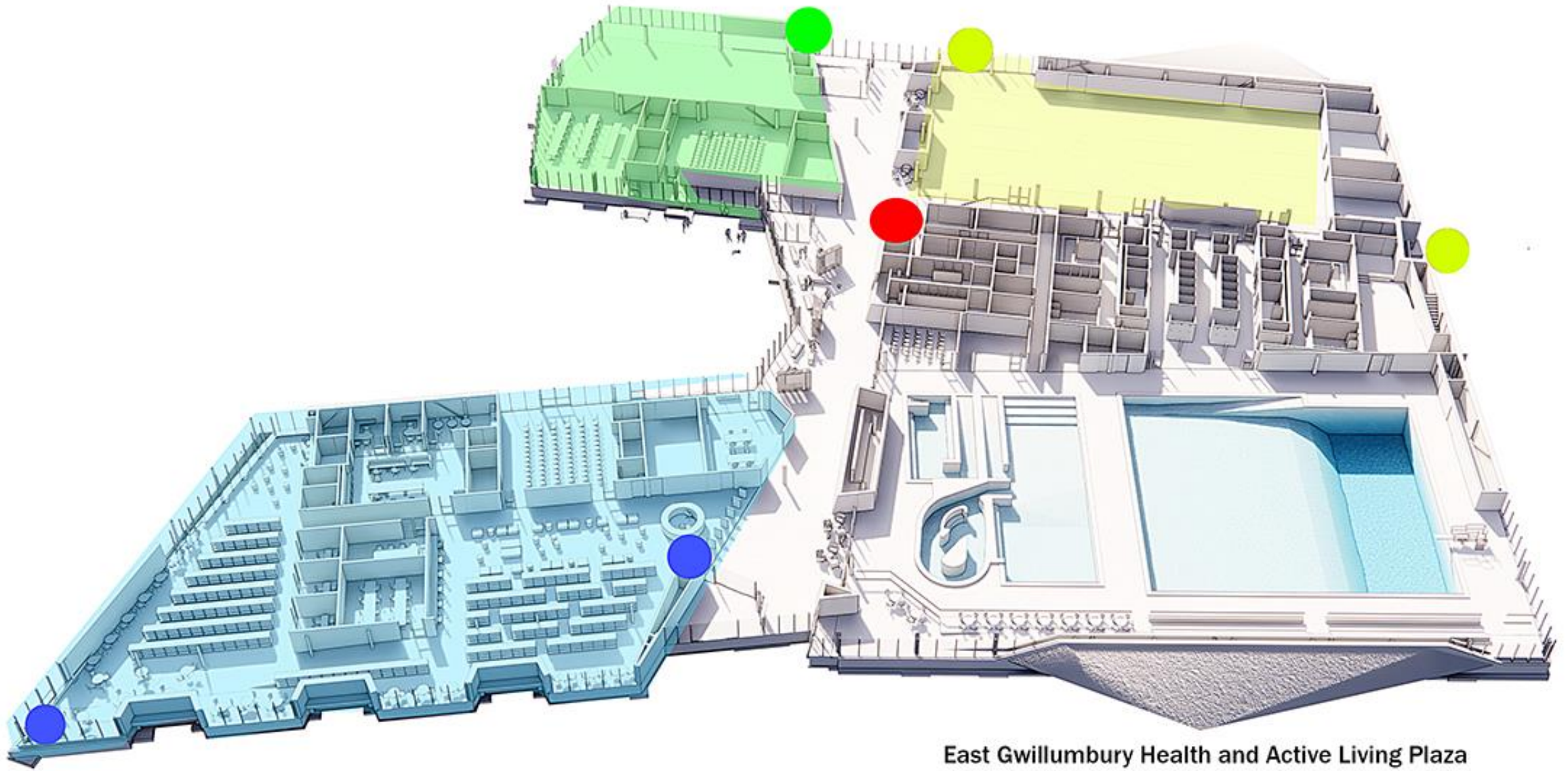

East Gwillumbury Health and Active Living Plaza



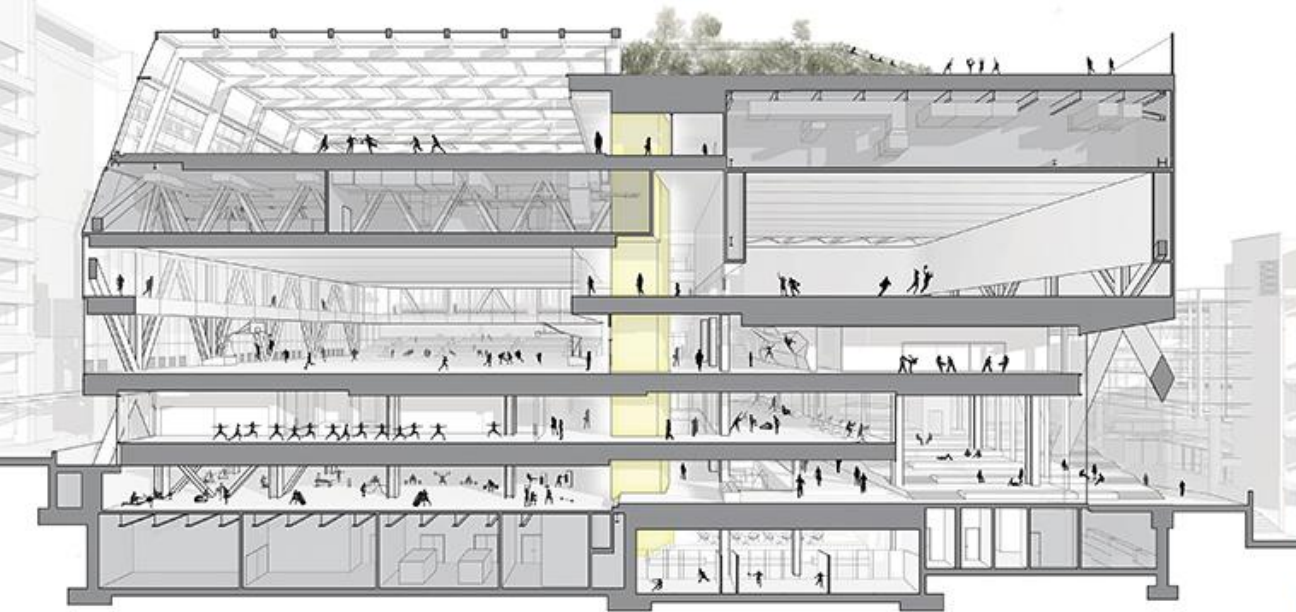

University of Auckland NZ Athletic Centre



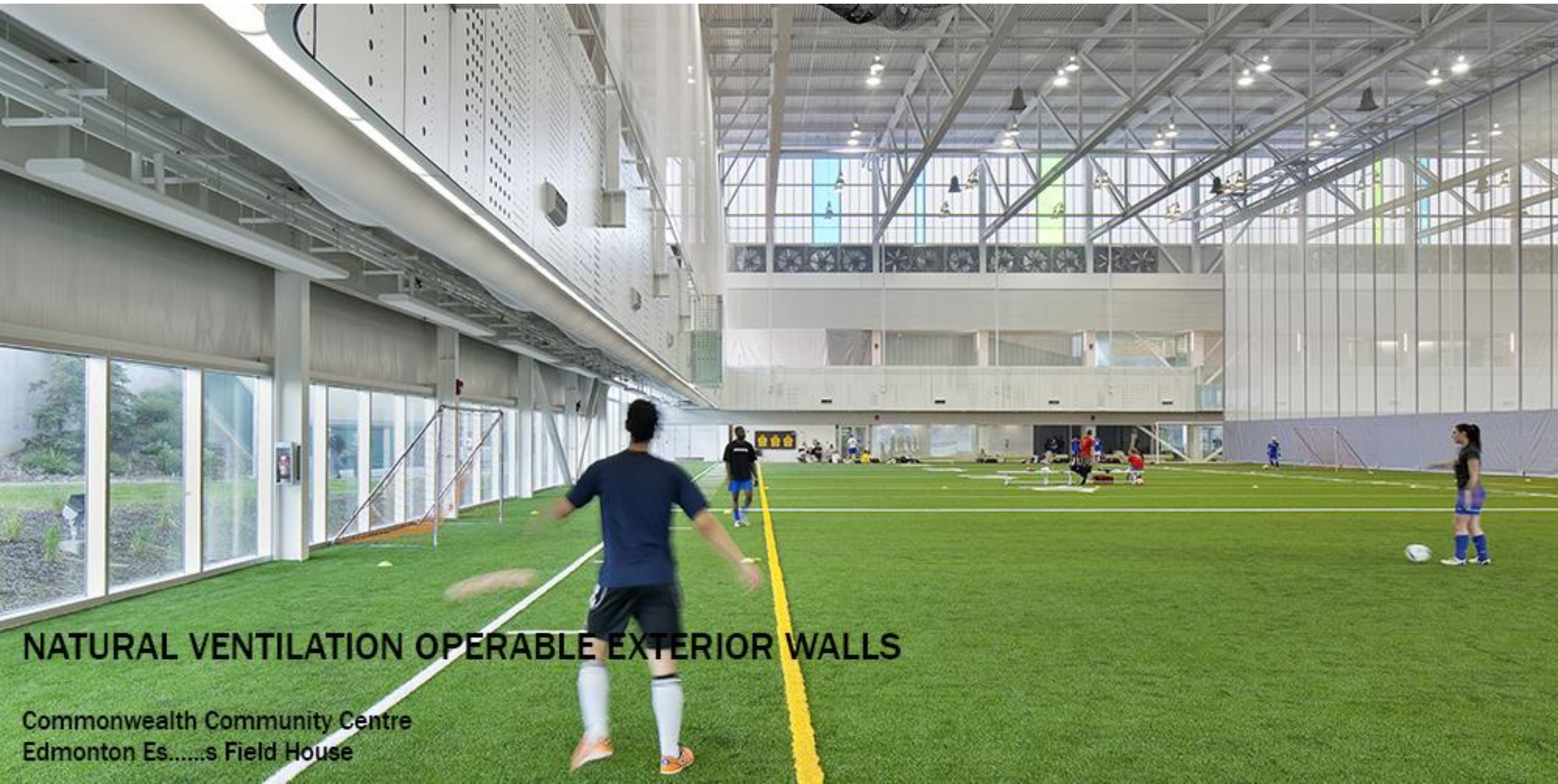

# NATURAL VENTILATION OPERABLE EXTERIOR WALLS

Commonwealth Community Centre  
Edmonton Es.....s Field House









Cooper Koo Family YMCA Toronto, Bostwick YMCA London





**Flush Pool Gutter Chloramine evacuation system**  
Milton Sherwood Recreation Centre



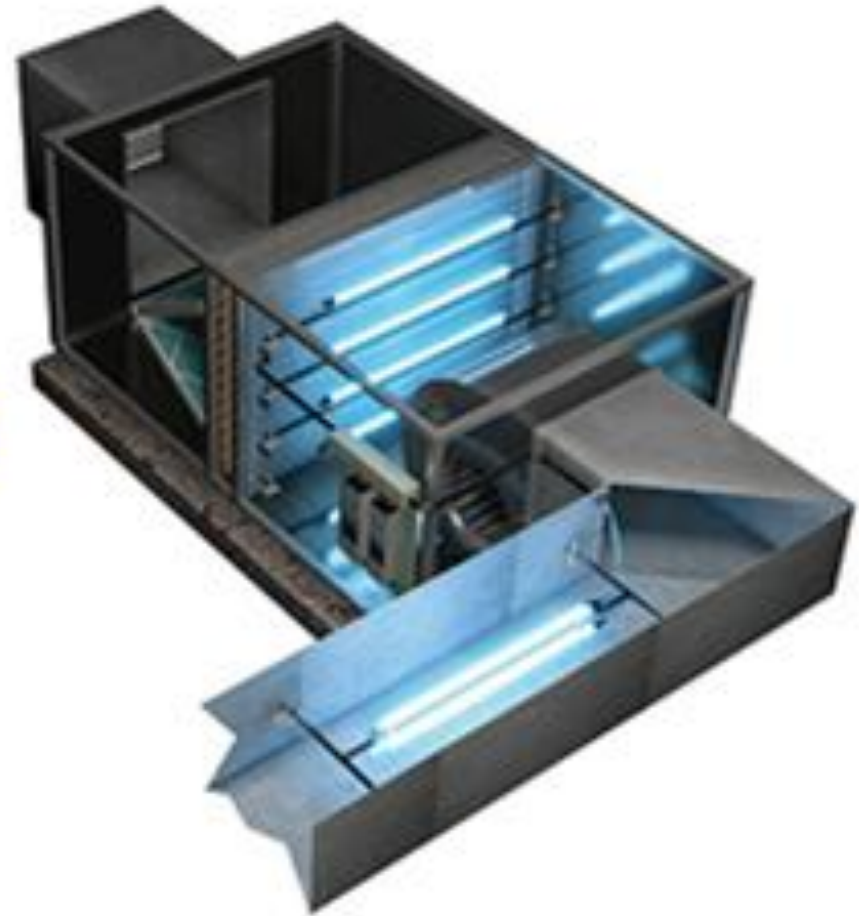

Bi-Polar Ionization





Rain Garden SWM







City of Toronto Bessarion Community Centre

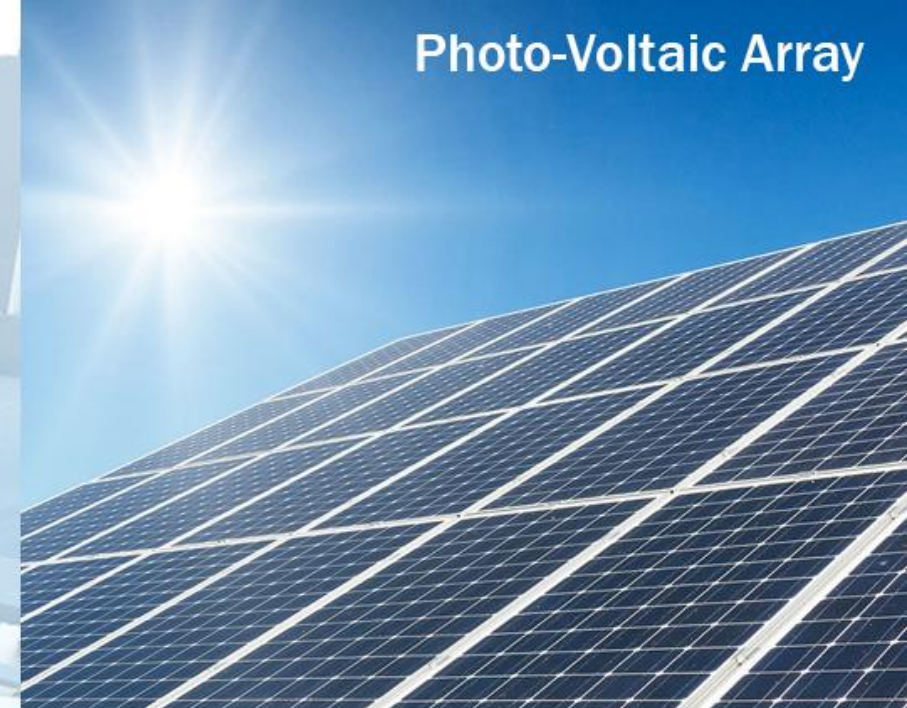

Photo-Voltaic Array



Hydronic Domestic Hot Water



# Colliers Project Leaders



**30** OFFICES  
ACROSS CANADA

**15,000+**  
PUBLIC AND PRIVATE  
SECTOR PROJECTS

**ISO**  
9001:2015

**30**  
YEARS OF SERVICE

# Project Planning

---

- Future pandemic design implications
- Update communications plans
- Account for added costs and timelines
- Plan Early



King Township Town Hall



Cornell Community Centre & Library



# Procurement Strategies

- Create procurement flexibility
  - Vendor of Record
  - OEM
- Balancing risk with bid prices
- Update ICIP funded projects design



# Construction Strategies

---

- Preconstruction services
- Update contract terms and conditions
- Revisit tender documents





# Public Health Review

- Multi / mixed-use spaces vs increase infection risk
- Infection control review by local authorities
- Decision-making and governance
- Health & Safety Pandemic Authority

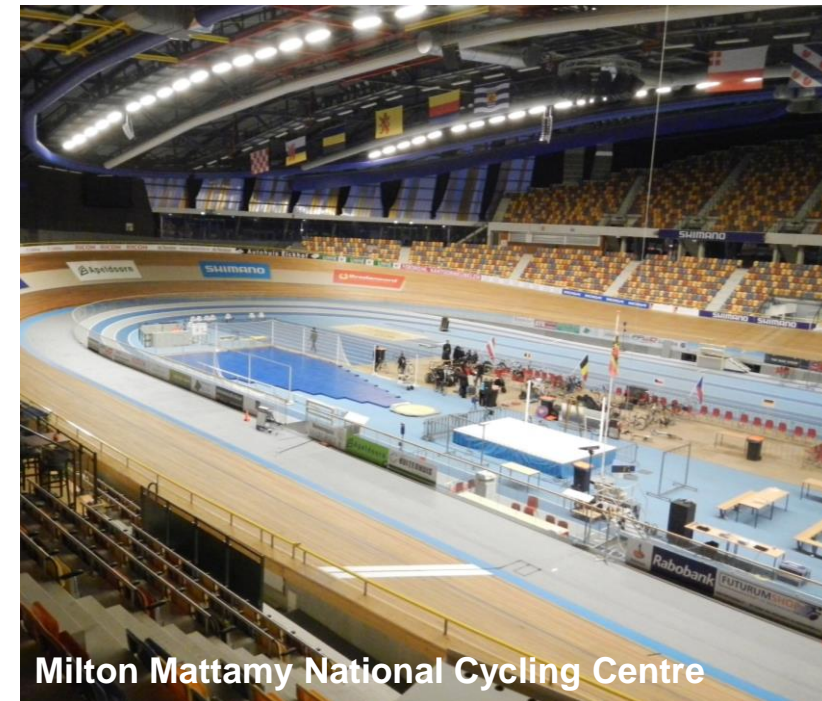

# Capital Forecasts

---

- Capital cost upgrades
- Project contingencies
- Tender prices
- Documentation is critical



Markham Fire Station



Atlas Tube Centre



# Operational Implications in a Post COVID World

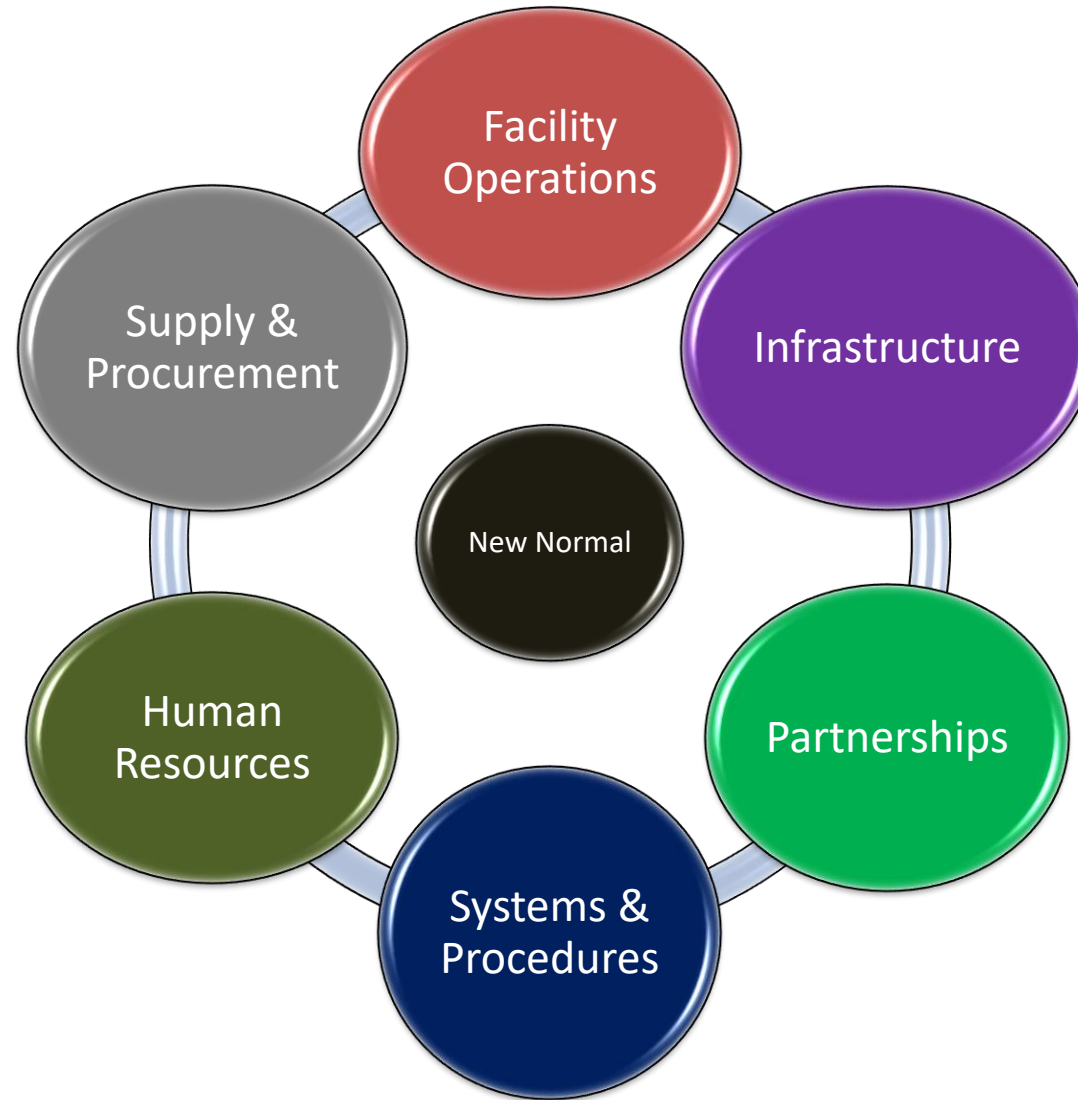

# Operations



- Public Health directives
- Reduced capacity
- Escalating labour needs
- Escalating utility usage



# Supply and Procurement

- New product needs
- New supply chains
- Training requirements
- Potential storage issues



# Human Resources



- New staff roles
- Staff as messengers
- New tasks/training required
- Maybe new mandated positions



# Systems and Procedures

- Imperative controls
- Operationalize directives
- Internal and external communications
- Monitor, evaluate and report



# Partnerships



- User groups & third party relationships
- Relationship review
- Financial, controls, reporting
- Monitor, evaluate and report



# Questions





**Miigwech  
Merci  
Thank You**

[www.prontario.org](http://www.prontario.org)

